

Safety Luminaire and Escape Sign Luminaire STYLE Industry 40011 CG-S



- Single-sided distribution escape sign or safety luminaire with robust diecast aluminium housing
- Large selection of screenprinted pictogram covers with simple snap mounting
- Maximum distance of 14 m from luminaire to luminaire with transparent cover
- Optional IP54 set for increased sealing requirements for indoor rooms or for canopied outdoor areas
- Shortened inspection effort due to **CEWA GUARD** technology
- Automatic function monitoring of up to 20 luminaires per circuit
- Reduced installation expenditure with **STAR** technology
- Freely programmable mixed operation of the switching modes per luminaire in one circuit



40011 CG-S
with transparent cover





40011 CG-S
with pictogram PR



Wire guard

Viewing distance	32 m
Luminous flux Φ_E/Φ_N at the end of rated operating time	75 %
Housing material	Coated aluminium
Weight incl. cover	2.3 kg
Housing colour	Grey RAL 7035
Type of mounting	Wall and ceiling mounting
Connection terminals	Loop terminals 3 x 2.5 mm ²
Connection voltage	220 - 240 V, 50/60 Hz 176 - 275 V DC
Current consumption - battery operation (220 V)	30 mA
Power consumption mains operation	16 VA
Permissible temperature range	-10 °C to +40 °C
Light source	8 W/T16, 450 lm

Ordering details

Type	Scope of supply	Order No.
40011 CG-S	Luminaire without cover with CG monitoring and 20-digit address switch	40071348401
Cover SL	Transparent cover	40071345985
Cover PL acc. to ISO 7010	Cover with silkscreened pictogram 	40071354130
Cover PR acc. to ISO 7010	Cover with silkscreened pictogram 	40071354131
Cover PU acc. to ISO 7010	Cover with silkscreened pictogram 	40071354133

Accessories

Type	Scope of supply	Order No.
IP54 supplement	Protective cover IP54 with mounting accessories	40071345975
Wire guard		40071348370
Ceiling mounting angle		40071348588
2 x M20 cable glands		40071348422

Dimensions in mm

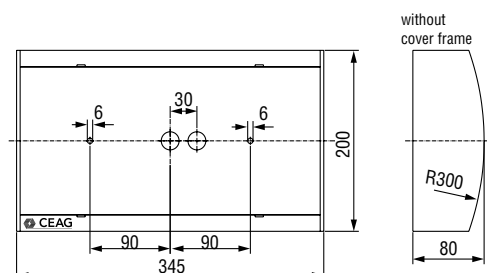

Safety Luminaire and Escape Sign Luminaire STYLE Industry 40011 CG-S

Planning help for 40011 CG-S for E = 1.0 lx (0.5 lx) with transparent cover

Measuring level 0.02 m, maintenance factor MF = 80 %, battery operation, distances in m

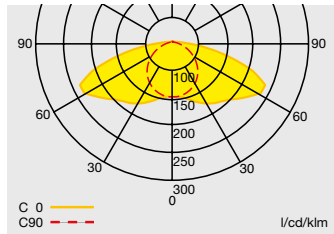

Light distribution curve 40011 CG-S with transparent cover

Mounting height (m)	Types of mounting	Mounting types			
		L1	L2	L3	L4
2.5	Ceiling mounting	2.9 (3.7)	7.4 (9.0)	5.1 (6.3)	12.4 (15.0)
3.0	Escape route centre	3.0 (3.9)	7.8 (9.8)	5.3 (6.8)	13.4 (16.4)
4.0		3.1 (4.3)	8.4 (11.0)	5.2 (7.4)	14.8 (18.8)
5.0		2.7 (4.3)	8.6 (11.6)	4.5 (7.4)	14.6 (20.4)
6.0		2.0 (4.2)	8.4 (12.0)	3.7 (7.1)	14.0 (21.0)
7.0		0.3 (3.9)	7.6 (12.2)	0.8 (6.4)	12.9 (20.8)
2.0	Wall mounting	2.8 (3.3)	6.6 (7.8)	3.4 (4.1)	8.2 (9.8)
2.5		2.9 (3.5)	7.0 (8.2)	3.2 (4.1)	8.2 (10.0)
3.0		2.9 (3.5)	7.0 (8.4)	– (3.9)	7.8 (10.0)
3.0	Ceiling mounting	2.4 (3.4)	7.8 (9.6)	5.5 (6.5)	13.6 (16.2)
4.0	Room illumination	2.4 (3.4)	8.6 (10.8)	5.5 (7.5)	15.2 (19.0)
5.0		2.4 (4.4)	8.8 (11.8)	4.5 (5.5)	16.2 (20.8)
6.0		1.8 (3.4)	8.8 (12.2)	3.0 (6.5)	16.0 (22.4)
7.0		0.7 (3.4)	8.8 (12.6)	0.7 (5.5)	15.2 (23.0)